

**PCB MOUNTING HOLES**

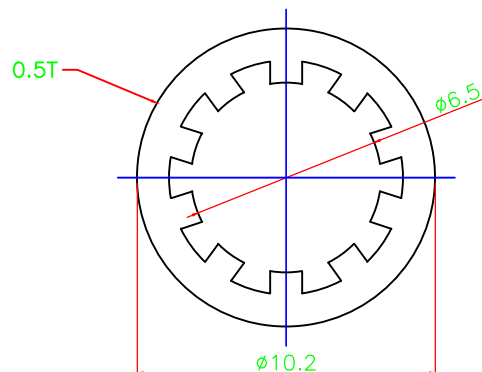
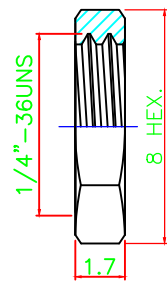
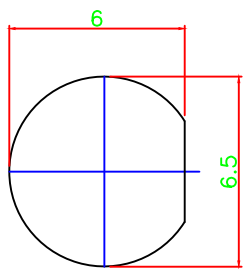

NO	Description	Material	Finish
1	Body	Brass	Gold
2	SQ. Body	Brass	Gold
3	Insulator	Teflon	-
4	Contact	P.H Bronze	Gold
5	Insulator	Teflon	-
6	Nut	Brass	Gold
7	Washer	Brass	Gold

*Dimensions Are In Millimeters Unless Otherwise Specified Tolerances*

0.5-6 = ± 0.2
6-30 = ± 0.4
30-120 = ± 0.6
120-315 = ± 1.0
315-1000 = ± 1.6
1000-2000 = ± 2.4

**ROHS COMPLIANT**

**COSMTEC** **COSMTEC RESOURCES CO., LTD**

DRAFT      CHECKED      APPROVED

The Drawing Contains Information That Is Proprietary To Cosmtec Resources Co., Ltd And Should Not Be Used Without Written Permission.      www.cosmtec.com

NO	Items	Specs
1	Impedance	50Ω
2	Frequency	DC~12.5 GHz
3	V.S.W.R	1.25 Max
4	Working Voltage	500V
5	Dielectric Withstanding Voltage	AC 1500V
6	Insulation Resistance	5000 MΩ Min
7	Contact Resistance	Center contact ≤ 3.0mΩ Outer contact ≤ 2.0mΩ
8	Temperture Range	-55°C ~ +165°C
9	Mating	Screw-On
10	Durability	500 Matings
11	Material/Finish	All RoHS Compliant

Part No.      S-037-19.4

Title: SMA JACK SOLDER BULKHEAD R/A FOR PCB MOUNT

DATE: AUG/11/2021      SCALE: 1:1      UNIT: m/m      REV: A